

FlexRail™

Aisle Containment System

WE KEEP
THE CLOUD
COOL™

Reduced Lift Time and Minimal 2-Person Operations

The FlexRail™ Aisle Containment System is a new approach to achieving enhanced field safety while reducing cost and improving speed. A smart double slotted extrusion design allows for easy, intuitive assembly and flexibility in field configuration and sizing.



Less Lift and Ladder Time

- Floor based assembly minimizes overhead work.
- Light weight structure enables easy lifting of assembly into ceiling with hand crank jacks.



Minimal Two-Person Operations

- Workers physically separated throughout the floor assembly and ceiling installation process.
- Single person on lift for ceiling attachment work.

Speed

- Floor assembly shortens construction time.
- Structural connections are all made with a single bolt type and size.



1148 SONORA COURT
SUNNYVALE, CA 94086
888.816.8338

FlexRail™

Aisle Containment System

WE KEEP
THE CLOUD
COOL™

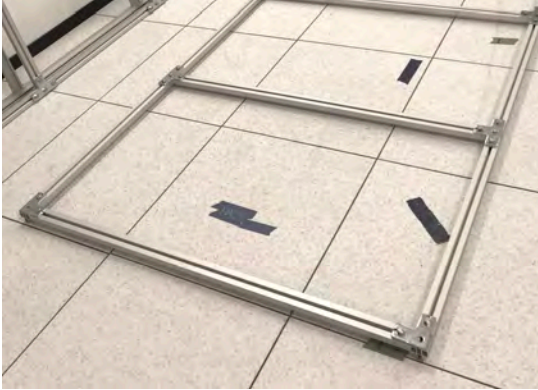

Pre-Fabrication at Factory

- All brackets are pre-installed at the factory saving field assembly time

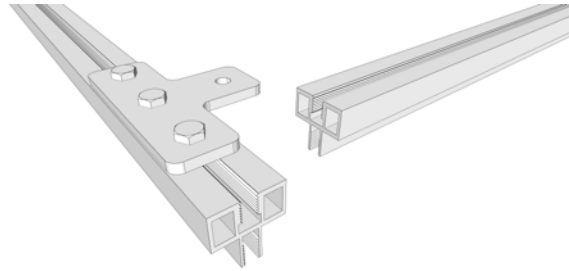

Speed

- Floor assembly is faster than ceiling stick build
- All assembly connection points are defined by pre-installed brackets so installers can't get it wrong



Safety

- 2-person operations are minimized for Covid safety
- Assembly on floor minimizes lift and ladder time



FlexRail Containment System Data Sheet

August 15, 2020

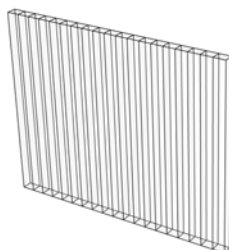
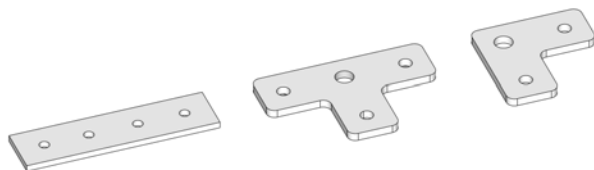
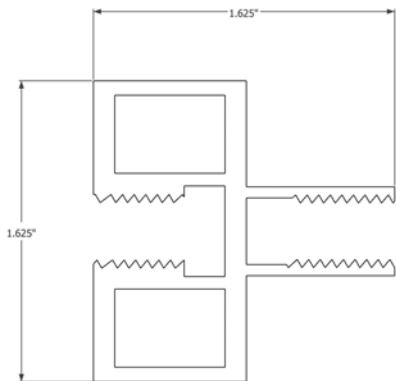
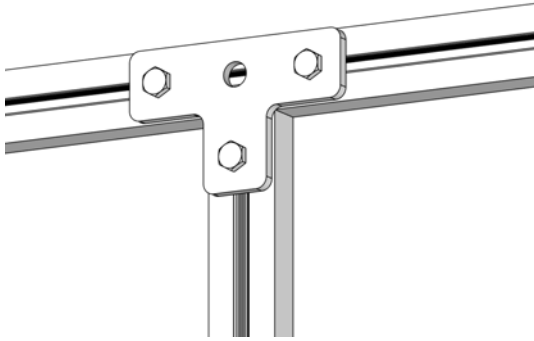

FlexRail SPECIFICATIONS

- A structural data center containment system of aluminum rails with surface mount connector plates and 8mm polycarbonate panel inserts.
- Designed to be assembled on floor and lifted into ceiling.
- Dual slot rail provides field flexibility in configuration and installation.
- Leakage performance:
 - Less than 1% pressure loss through panel assembly at pressure of 0.05" of water
- Weight of 44' long x 6.5' tall x 4' wide HAC:
 - 520 lbs. or 12 lbs./ft. along length
- Weight of 30' long x 4' tall x 4' wide HAC:
 - 356 lbs. or 12 lbs./ft. along length

MAIN EXTRUSION

- H 1.625" x W 1.625"
- 6063-T6 Anodized Aluminum
- Dual 3/8-16 screw slot threaded bosses run continuously along extrusion.
- Less than L/200 deflection in either direction under normal air pressure or system load.

PLATE CONNECTORS

- Tabbed for quick alignment.
- Galvanized steel at 0.125" and 0.25" thick.
- Connected to grid members with 3/8-16 x 3/4" Hex Head Machine Bolts.
- Typical Unistrut connectors may be used as substitutes.

PANEL INSERTS

- 8mm Twinwall Polycarbonate
- Meets Class A Flame and Smoke Development